

The instructions below are provided as a reference tool for caregivers who are already familiar with the use of an insulin pump and with insulin therapy in general. Not all screens are shown. For more detailed information on the operation of the t:slim X2 insulin pump, please refer to its user guide.

Stop insulin delivery

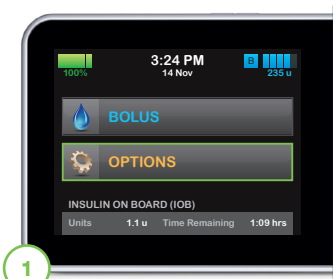

1 Tap **OPTIONS**.



2 Tap **STOP INSULIN**.

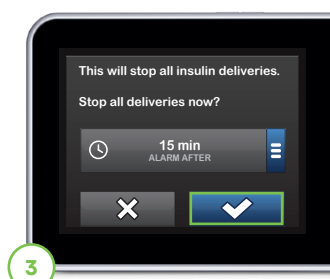

3 Tap to accept the displayed setting. To change the Resume Pump Alarm setting, tap the panel in the middle of the screen.

Note: The pump will NOT automatically resume insulin delivery after the time has elapsed. The user will receive a Resume Pump Alarm after the selected duration (15 min, 30 min, 45 min, or 1 hour).



4 Select the button that corresponds with the time you would like the Resume Pump Alarm to display.

If a different value is selected, the pump will return to the previous confirmation screen with the updated selection.

Resume insulin delivery

Note: If the timer of a temp rate is still active when insulin is resumed, the temp rate will continue. If any bolus is being delivered before you stop insulin, the remaining insulin to be delivered will be canceled.

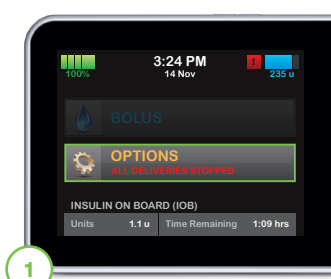

1 Tap **OPTIONS**.



2 Tap **RESUME INSULIN**.

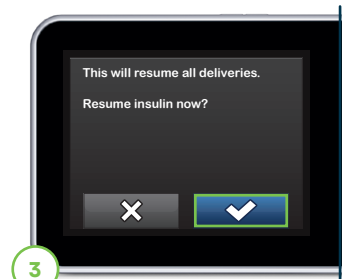

3 Tap to confirm.

Important Safety Information: RX ONLY. Tandem insulin pumps are intended for the subcutaneous delivery of insulin, at set and variable rates, for the management of diabetes mellitus in persons requiring insulin. The t:slim X2 insulin pump is approved for individuals 6 years of age and older. For Important Safety Information, please visit tandemdiabetes.com/safetyinfo.

© 2022 Tandem Diabetes Care, Inc. All rights reserved. Tandem Diabetes Care and t:slim X2 are either registered trademarks or trademarks of Tandem Diabetes Care, Inc. in the United States and/or other countries. ML-000315_H

